

#42 Plaster Box

#44 Plaster Box



#42 Plaster Box



#44 Plaster Box

A plaster box is used to mount a wall panel into the wall in new construction where the box can be attached to the stud before drywall is installed. The plaster box provides a secure mount for the panel, a secure grip on the cable, and protection for the connections to the terminal screws on the panel.

If drywall has been installed prior to installation, a #22 mounting frame or #24 mounting frame should be used instead of a plaster box.

The box should protrude in front of the stud almost

the thickness of the drywall to be installed. If the box is not near level, it should have shims installed under one of the mounting tabs to level it.

Cables should enter the box through some kind of bushing or a romex clamp to protect the cable from the sharp edges of the box.

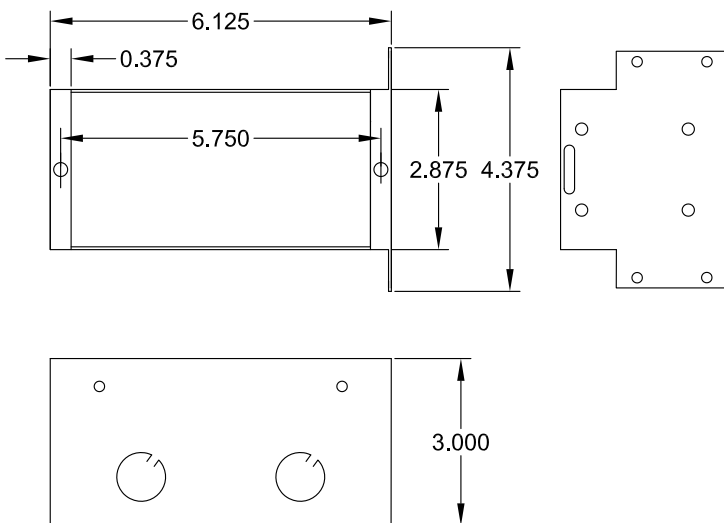

#42 Plaster Box

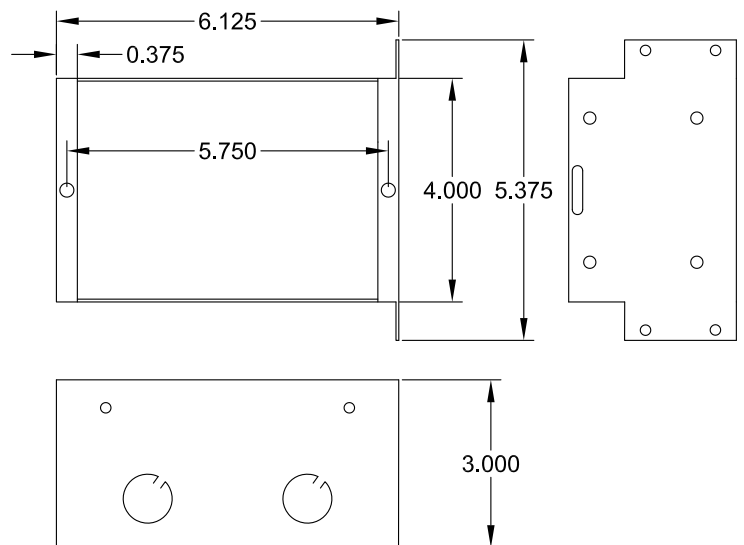

#44 Plaster Box